

LUMBINI

Portable Hydrogen Water Generator

Portable Hydrogen Water Generator Manual

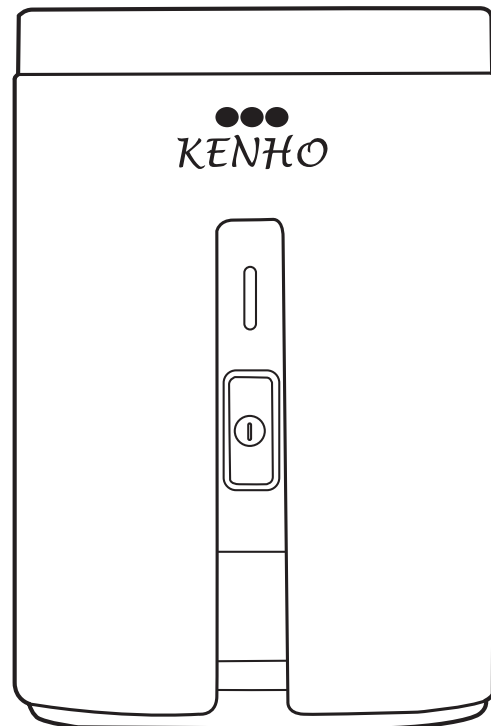

KENHO

Table of Contents

- SAFETY INSTRUCTIONS 3
- COMPONENTS 5
- NAMES OF PARTS 6
- HOW TO CHARGE 7
 - CHARGING THE PRODUCT 7
- HOW TO USE 8
 - INSTRUCTIONS 8
- WHAT TO DO AFTER USE 10
 - REMOVING WASTED WATER 10
 - WASHING THE PRODUCT 10
 - CLEANING THE PRODUCT 11
 - CHECKING THE SILICON RING 11
 - STORING THE PRODUCT 11
- WHAT TO CHECK BEFORE CLAIM 12
- SPECIFICATION 12
- REGULATIONS 13
- WARRANTY 15

SAFETY INSTRUCTIONS

The below instructions must be followed in order to use this product properly and safely. When the below instructions are not properly followed, injuries or property damages can occur.



INDICATES A POTENTIALLY HAZARDOUS SITUATION WHICH, IF NOT AVOIDED, MAY RESULT IN DEATH OR SERIOUS INJURIES.



INDICATES A POTENTIALLY HAZARDOUS SITUATION WHICH, IF NOT AVOIDED, MAY RESULT IN INJURIES OR PROPERTY DAMAGE.

IN RELATION TO ELECTRIC POWER



WARNING

- **DO NOT USE DAMAGED POWER PLUG OR LOOSE SOCKETS**
 - If the power is not connected properly, it may cause fire, electric shock, or failures.
- **DO NOT PULL THE POWER PLUG TO RELOCATE THE PRODUCT**
 - It may cause fire or failures.
- **DO NOT DAMAGE OR MODIFY THE PRODUCT BY BENDING THE POWER CORD OR PLACING HEAVY OBJECTS ON TOP**
- **DO NOT TOUCH POWER PLUG OR CORD WITH WET HAND**
 - It may cause fire, electric shock, and failures.
- **DO NOT REPETITIVELY PLUG AND UNPLUG THE POWER CORD**
- **DO NOT CONNECT THE POWER CORD TO THE PRODUCT FOR A LONG PERIOD OF TIME (5 HOURS OR MORE)**
- **UNPLUG WHEN NOT USING THE PRODUCT FOR LONG TIME**
- **WHEN CHARGER PLUG IS WET, UNPLUG AND DRY COMPLETELY BEFORE USING AGAIN**
- **UNPLUG BEFORE REPAIRING, INSPECTING OR REPLACING COMPONENTS**
 - It may cause fire or failures.
- **KEEP THE PRODUCT AWAY FROM CHILDREN'S REACH**
- **DO NOT MODIFY OR REPLACE THE MAIN BODY OF THE PRODUCT**
 - It may cause electric shock or fire.
- **IMMEDIATELY STOP USING THE PRODUCT IF THE PRODUCT PRODUCES SMOKE OR A STRANGE SCENT.**
 - Immediately stop the operation, unplug the charger, and contact the service center. If you continue operation, it may cause electric shock, fire, or failures.



CAUTION

- **USE THE PRODUCT AFTER CHARGING BY CONNECTING THE PRODUCT TO THE CHARGER FIRMLY.**
 - If poorly connected, it may cause fire or failures.

IN RELATION TO USING



WARNING

- WHEN ABNORMALITY DETECTED, STOP USING THE PRODUCT IMMEDIATELY
- DO NOT LET CHILD USE THE PRODUCT WITHOUT ADULT'S CARE
- ONLY USE CHARGERS WITH INPUT OF AC 100V~240V AND OUTPUT OF DC 8.4V
 - It may cause electric shock or fire.
- DO NOT INAPPROPRIATELY MODIFY, DISASSEMBLE, OR REPAIR THE PRODUCT
 - It may cause electric shock, fire, or failures.
- DO NOT STEP ON THE POWER CORD OR DAMAGE THE CORD
 - It may cause electric shock, fire, or failures.
- ONLY USE THE CHARGER PROVIDED WITH THIS PRODUCT
- STOP USING THE PRODUCT IF ABNORMALITY IS DETECTED INCLUDING DISCOLORATION, OVERHEATING, AND STRANGE SCENT
 - UNPLUG IMMEDIATELY AND CONTACT SERVICE CENTER.
- IF YOU COME IN CONTACT WITH THE BATTERY LIQUID, WASH AWAY IMMEDIATELY
 - This may cause skin damage.
- DO NOT PRESS POWER BUTTON BEFORE CONNECTING THE WATER BOTTLE TO THE PRODUCT
 - It may cause damage to the Astra Cell.



CAUTION

- DO NOT USE WATER TEMPERATURE ABOVE 80°C
 - This may cause abnormal operation.
- DO NOT USE DRINKS WITH DEPOSITS OR VISCOSITY SUCH AS CARBONATED DRINKS, GREEN TEA, OR 100% JUICES WHEN USING THIS PRODUCT
 - When the above drink types are used, it may cause failures due to foreign substances affecting the electrodes
- USING DRINKABLE WATER IS RECOMMENDED. IF ANY BEVERAGE OTHER THAN WATER IS USED, PLEASE CLEAN THE PRODUCT WITH CITRIC ACID WITHIN 1 HOUR.
 - If the product is not cleaned with citric acid or left alone, it may cause failures or abnormal odor. Please refer to page 10, "Cleaning the Product" for more information about citric acid cleaning method.
- WHEN USING THE PRODUCT FOR THE FIRST TIME OR USING IT AFTER A LONG PERIOD OF TIME (1 WEEK OR MORE), RUN IT 2 OR 3 TIMES. THIS HELPS TO CLEAN THE PRODUCT AND SOAK THE ELECTRODE OF HYDROGEN GENERATOR WITH WATER.
 - If the product is used when the hydrogen generator is completely dried, it may take more time to generate the hydrogen when operating.
- BEFORE CHARGING, DRY THE PRODUCT
 - It may cause electric shock, or failures.
- STOP USING WHEN THE PRODUCT IS DAMAGED BY ANY IMPACT
 - It may cause electric shock, fire, or failures.
- WHEN USING, PLACE THE PRODUCT ON FLAT SURFACE
- EXTERNAL SHOCK SHOULD BE AVOIDED
- DO NOT FREEZE THE PRODUCT
- DO NOT USE WATER WITH IMPURITIES
 - It may cause damage to the cord.
- DO NOT WASH THE INSIDE OF THE PRODUCT WITH CHEMICAL DETERGENT

COMPONENTS

PLEASE CHECK THAT COMPONENTS BELOW ARE INCLUDED.

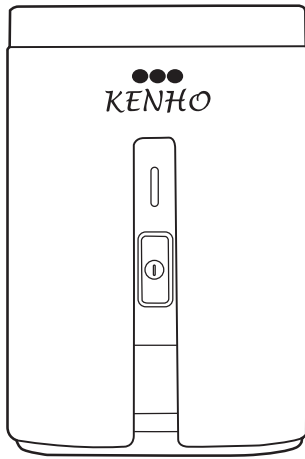

MAIN BODY

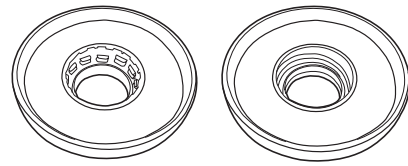

BOTTLE
ADAPTER

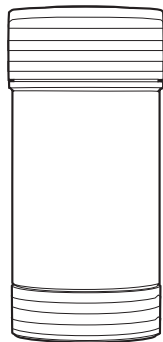

TUMBLER

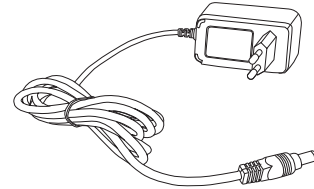

CHARGER

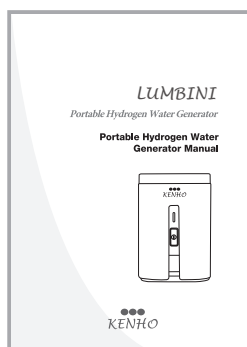

MANUAL

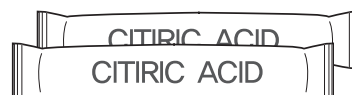

CITRIC ACID
(Can be purchased separately)

NAME OF PARTS

FRONT VIEW

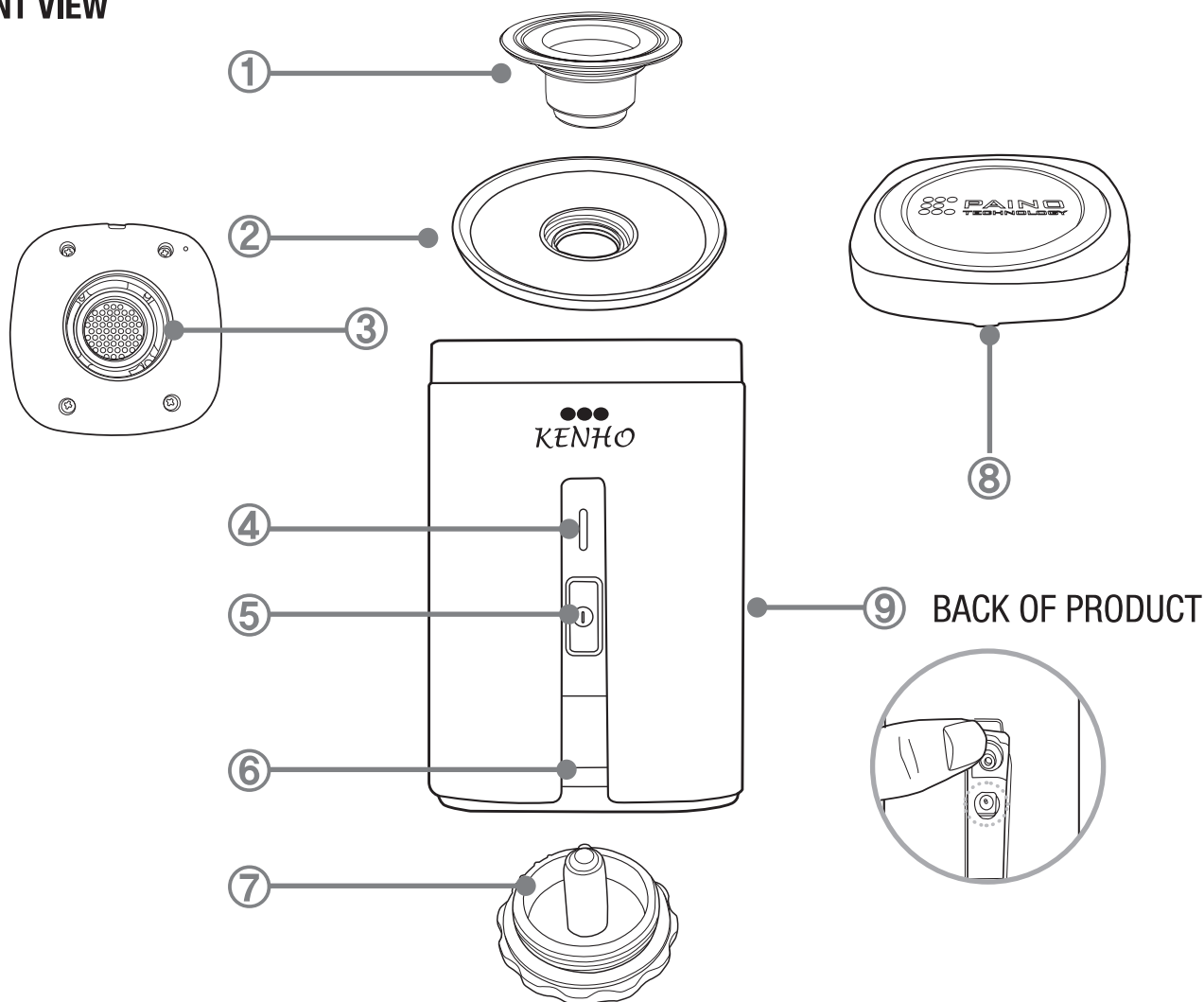

No.	NAME	FUNCTION
①	BOTTLE ADAPTER PROTECTION CAP	PROTECTS MAIN BODY FROM DIRT
②	BOTTLE ADAPTER	COMBINES THE PRODUCT WITH WATER BOTTLE
③	ASTRA CELL	GENERATES HYDROGEN BUBBLES
④	LED	SHOWS STATUS OF THE PRODUCT - AFTER THE POWER TURNS ON, WHITE LED TURNS ON DURING THE 3 MIN MODE AND WHITE LED BLINKS DURING THE 5 MIN MODE - DISPLAYS LOW VOLTAGE STATUS (RED LED BLINKS), OVERCURRENT STATUS (RED LED TURNS ON FOR 5 SEC)
⑤	POWER BUTTON	TURNS ON/OFF THE PRODUCT AND CREATES HYDROGEN WATER
⑥	DRAINAGE BASIN	COLLECTS WASTED WATER UPON GENERATION OF THE HYDROGEN WATER
⑦	BASIN PLUG	USES WHEN REMOVING THE WASTED WATER UPON GENERATION OF THE HYDROGEN WATER
⑧	PROTECTION COVER	PROTECTS MAIN BODY FROM FOREIGN SUBSTANCES
⑨	CHARGER PLUG	CONNECT TO THE REAR SIDE OF PRODUCT TO CHARGE AND CONNECT THE CHARGING TERMINAL

HOW TO CHARGE

CHARGING THE PRODUCT

- ① DRY THE PRODUCT COMPLETELY TO PLACE THE PRODUCT ON FLAT SURFACE.
- ② OPEN CHARGER PLUG COVER ON REAR SIDE OF THE PRODUCT.
- ③ CONNECT CHARGER TO THE PRODUCT AND PLUG INTO WALL SOCKET.
- ④ WHILE CHARGING, LED IS TURNED RED.
- ⑤ WHEN CHARGING COMPLETED, LED IS TURNED GREEN.
- ⑥ WHEN CHARGING COMPLETED, DETACH CHARGER FROM THE PRODUCT AND CLOSE CHARGER PLUG COVER.

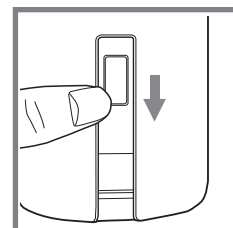
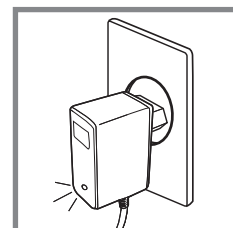
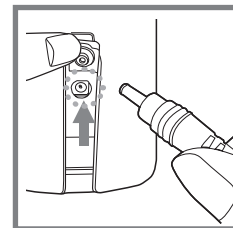
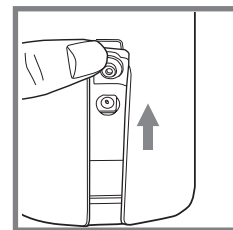
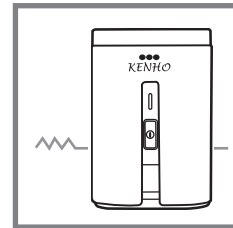

※ NOTICE

BEFORE FIRST USE, CHARGE THE PRODUCT FULLY.

.....

※ LOW CURRENT WARNING

WHEN RED LED BLINKS, CHARGE THE PRODUCT
- WHEN RED LED BLINKS DURING CONTINUOUS OPERATION,
THIS INDICATES THAT THE PRODUCT IS NOT WORKING.

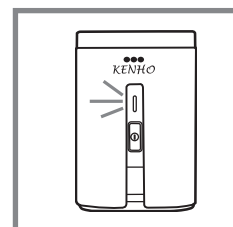

HOW TO USE

INSTRUCTIONS

<CHECK HYDROGEN WATER PRODUCING MODE>

- 3 MIN MODE: SUITABLE FOR 300ML TUMBLER
- 5 MIN MODE: SUITABLE FOR 500ML TUMBLER

white led blinks when the operation switch is held for at least 2 sec (5 min mode).

- ① DETACH PROTECTION COVER FROM THE PRODUCT
TO PLACE THE PRODUCT ON FLAT SURFACE

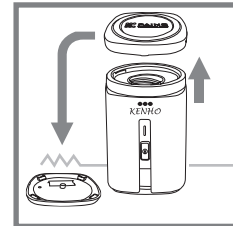

- ② MAKE SURE THAT HYDROGEN GENERATOR IS CLEAN
- WHEN HYDROGEN GENERATOR IS NOT CLEAN, REMOVE DIRT ON IT.

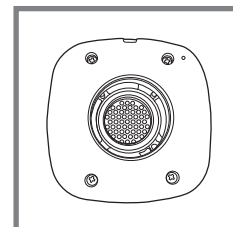

- ③ TURN THE PRODUCT UPSIDE DOWN AND COMBINE IT WITH WATER BOTTLE.
- IF THE PRODUCT AND WATER BOTTLE DOES NOT FIT, LEAKAGE MIGHT OCCUR.

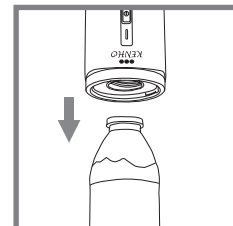

- ④ TURN UPSIDE DOWN AGAIN TO PLACE THE BOTTLE AT THE TOP AND
THE MAIN BODY AT THE BOTTOM
- PLACE THE PRODUCT ALWAYS ON THE FLAT SURFACE.

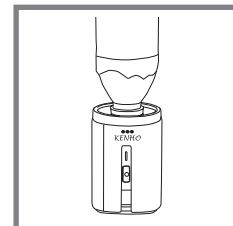

stand the product on protection cover.
- when the product is on soft surface,
it might not work properly.

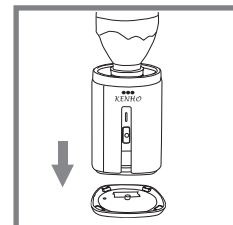

- Do not use glass and metal bottle other than pet bottle. this may cause failure or injury due to increased pressure in the bottle.
 - Avoid using pet bottle which has been used at least once or has not been cleaned. it may induce germ proliferation or hygiene issues.
 - Do not use water exceeding the heat-resistant temperature of the pet bottle.
 - If the pet bottle is broken due to high temperature it may cause damage or failure.
- if you use the tumbler for this product, please use the water with temperature $\leq 80^{\circ}\text{C}$.

- ⑤ WHEN POWER BUTTON IS PRESSED, HYDROGEN BUBBLES ARE GENERATED AS WHITE LED IS ON.

- WHEN USING BOTTLE ADAPTER (SMALL SIZE), IT SHOULD BE GENERATED TWICE TO GENERATE HIGH-DENSITY HYDROGEN WATER ($\geq 1,000$ ppb)

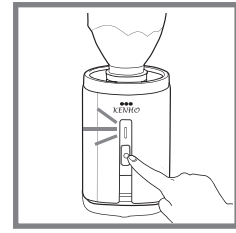

WARNING

- AVOID GENERATING HYDROGEN MULTIPLE TIMES WHEN THE BOTTLE IS MOUNTED. IF IT'S GENERATED MULTIPLE TIMES, REMOVE INTERNAL PRESSURE IN THE BOTTLE ONCE THE HYDROGEN IS GENERATED.
- WHEN IT'S GENERATED MULTIPLE TIMES, INTERNAL PRESSURE IN THE BOTTLE WILL INCREASE WHICH LEADS TO CAUSE DAMAGE OR FAILURE.

- ⑥ HYDROGEN BUBBLE GENERATES FOR 3 MINUTES OR 5 MINUTES. WHEN COMPLETED, IT STOPS AUTOMATICALLY (DEPENDS ON THE GENERATION MODE).



- ⑦ TURN THE PRODUCT UP SIDE DOWN TO PREVENT WATER FALL. THEN SEPARATE THE PRODUCT FROM THE BOTTLE.

- DISASSEMBLE THE BOTTLE WHILE HOLDING THE BOTTLE ADAPTER. IF NOT, BOTTLE AND BOTTLE ADAPTER MAY BE DISASSEMBLED TOGETHER.

- DRINK IMMEDIATELY AFTER OPERATION. WHEN YOU KEEP BOTTLE UP SIDE WITHOUT SEPARATE LONG TIME, LEAKAGE MIGHT BE OCCURED

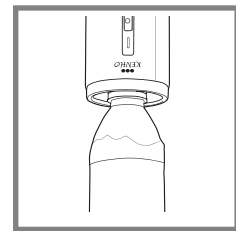

WARNING

※ **NEVER USE CARBONATED WATER.**

- IT CAN EXPLODE DUE TO INCREASED INTERNAL PRESSURE.

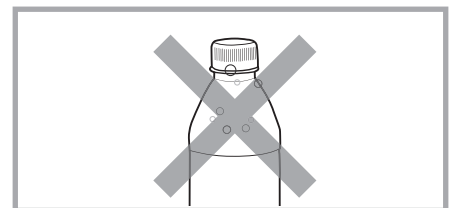

※ **DO NOT USE UNDER HUMID ENVIRONMENT.**

- SAUNA, RAINY OUTDOOR



WHEN USING WATER WITH EXCESSIVE MINERAL, RED LED TURNS ON FOR 5 SEC AND THE PRODUCT TURNS OFF AUTOMATICALLY.

- THIS MAY CAUSE PRODUCT FAILURE.

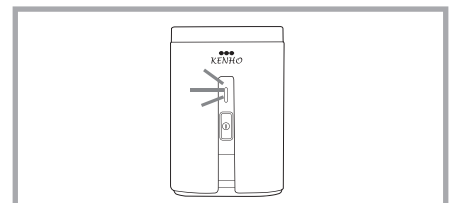

WHAT TO DO AFTER USING

REMOVING WASTED WATER

- ① WHEN DRAINAGE BASIN IS MORE THAN HALF-FILLED, DRAIN THE WASTED WATER.

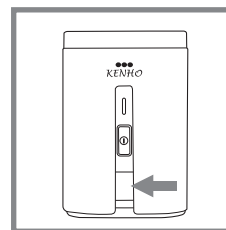

- ② OPEN DRAINAGE PLUG AND REMOVE WASTED WATER.

※CAUTION

avoid wasted water from leaking into main body when disposing the water by placing the product upside down.

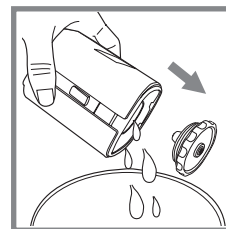

- ③ DRY THE PRODUCT AND CLOSE DRAINAGE PLUG.

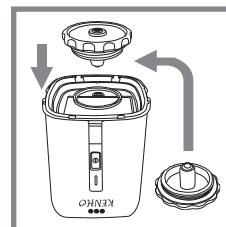

WASHING THE PRODUCT



NEVER WASH THE PRODUCT WITH FLOWING WATER OR SOAK THE PRODUCT INTO WATER.

• PERIODIC CLEANING

CLEAN THE PRODUCT ROUTINELY WITH CITRIC ACID.

- fill water bottle with water (250ml) and citric acid 5g. shake the bottle 2-3 times and drain all of the water.

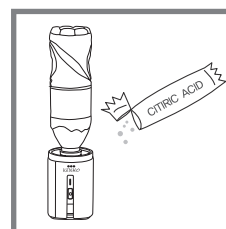

• REMOVING CALCIUM COMPOUNDS

WHEN USED MANY TIMES, CALIUM COMPOUNDS(SODIUM, MINERAL) MIGHT CUMULATES ON HYDROGEN GENERATOR.

- fill water bottle with water(250ml and citric acid 5g. combine the water bottle with the product and leave it for 1 hour.

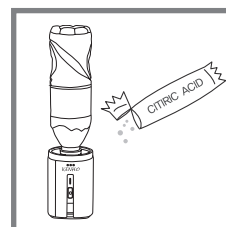

• CLEANING WHEN SMELLS

WHEN USED MANY TIMES, HYDROGEN GENERATOR MIGHT SMELL.

FILL HOT WATER(60~80) INTO HYDROGEN GENERATOR AND WAIT 3~5 MINUTES. REMOVE THE WATER.

- smell does not affect to hydrogen generating and taste of water.

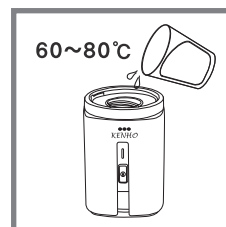

CLEANING THE PRODUCT

- **GENTLY WIPE THE BODY WITH SOFT TOWEL.**

- keep the product dry after cleaning.

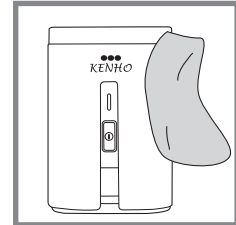

- **CLEAN HYDROGEN GENERATOR WITH SOFT FABRIC OR SPONGE.**

- when dirt is not removed, combine the product with water bottle filled with a half of water and shake a few times. After cleaning the inside of the product, Immediately drain the water.

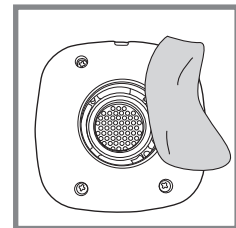

CHECKING THE SILICON RING

- **CHECK THE TRANSPARENT SILICON RING IS ON THE BOTTLE. ADAPTER**

- **PLEASE BE CAREFUL AS THE SILICON RING MAY BE DIVIDED FROM THE ADAPTER WHEN YOU SEPERATE THE BOTTLE.**

- in case of silicon ring dividing, put silicon ring on the adapter and push that slightly.

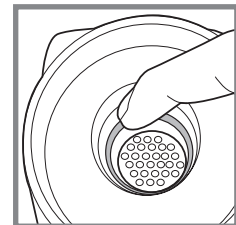

STORING THE PRODUCT

- **KEEP COVER CLOSED WHEN NOT USING THE PRODUCT.**

- **BE AWARE THE POWER IS ON WITH PUSH POWER BUTTON UNINTENDEDLY.**

- **DO NOT STORE THE PRODUCT AROUND HEATER OR WHERE TEMPERATURE GOES BELOW 0°C**

WHAT TO CHECK BEFORE CLAIM

PLEASE CHECK BELOW BEFORE CONTACTING REGIONAL SERVICE CENTER

SYMPTOM	CHECK	WHAT TO DO
HYDROGEN GENERATOR DOES NOT WORK	<ul style="list-style-type: none">• IF IT IS CHARGED• IF CELL IS DIRTY	<ul style="list-style-type: none">• CHARGE THE PRODUCT• CLEAN MAIN BODY REFERRING TO PAGE 11 "CLEANING THE PRODUCT"
LED DOES NOT WORK	<ul style="list-style-type: none">• IF IT IS CHARGED	<ul style="list-style-type: none">• CHARGE THE PRODUCT
THE PRODUCT IS NOT CHARGED	<ul style="list-style-type: none">• IF CHARGER IS PROPERLY CONNECTED	<ul style="list-style-type: none">• CONNECT BODY AND CHARGER PROPERLY

UTD ASIA PTE. LTD. Co Reg. No 201203877C

10 Anson Road #26-10,
International Plaza
Singapore 079903

Website: www.kenho-products.com

SPECIFICATION

SPECIFICATION	DETAILS
MODEL NAME/PRODUCT NAME	LUMBINI / PORTABLE HYDROGEN-RICH WATER GENERATOR
POWER CONSUMPTION	10W
DIMENSION (W x H x D)	72 x 104 x 72 (Unit: mm)
WEIGHT	274g (MAIN BODY)
POWER ADAPTER	INPUT: AC 100~240V, OUTPUT: DC 8.4V
HYDROGEN GENERATION TIME	3 MINUTES / 5 MINUTES
CHARGING TIME	90 MINUTES (8-10 TIMES CAN BE USED WHEN FULLY CHARGED)

-
1. This product is warranted for the specified warranty period against defects in quality and materials under normal use. Also, manufacturer's responsibility is limited to repair and exchange of product upon conditions specified in this warranty.
 2. Warranty period is 1 year from the day the product is purchased.
 3. Warranty period is 1 year from the date of purchase for initial defect and failures under the use as specified in the instruction manual or repair/exchange according to this warranty provisions.
 4. Receipt can replace sign of seller on warranty.
 5. For free repair within warranty period,
 - Bring your product along with your warranty certificate to where you purchased product to get serviced
 - Substitute is not offered while repairing.
 - Damages incurred due to using/unable to use this product (loss of profit, discontinuation of business, damages due to failure or reckless use of this product, and other financial damage) will not be reimbursed.
 - If you want to repair this product by shipping, please ship this product along with the warranty certificate.
 6. Even though it's within the warranty period, it will not be covered by the warranty when,
 - Disassembling this product or there are signs of disassembling attempts
 - Failure or damage occurred due to relocation, shipping, or falling after the purchase (for online purchase, it shall be applied upon the arrival); or due to fire, earthquake, flood, heavy snow, natural disaster, etc.; Or when the warranty certificate is not submitted.
 - There is no written date, customer name, or vendor in the warranty; or receipt is not attached; or when the content is improperly revised.

This warranty is valid only in Korea. Since this warranty cannot be re-issued, please keep it safely.

In addition, warranty provisions can be changed without prior notification.

Warranty promises free repair and exchange of product within specified period upon terms and conditions.

This warranty does not restrict your legal rights. For services after the warranty period, please contact the store where you purchased the product.

WARRANTY

PRODUCT NAME	PORTABLE HYDROGEN-RICH WATER GENERATOR	MODEL NAME	LUMBINI
SERIAL No.			
CUSTOMER'S NAME		PHONE	
ADDRESS			
SELLER		PHONE	
ADDRESS			
PURCHASED DATE			

1. THIS PRODUCT HAS QUALIFIED RIGOROUS QUALTY CONTROL.
2. WITHIN WARRANTY PERIOD, SERVICE IS FREE OF CHARGE.
3. WHEN FAILURE OCCURS, PLEASE CONTACT REGIONAL SERVICE CENTER.
4. BRING WARRANTY TO GET SERVICE.
5. FILL ABOVE BLANKS WHEN PURCHASING THE PRODUCT.

WARRNATY

1. THIS PRODUCT IS WARRANTED FOR THE SPECIFIED WARRANTY PERIOD AGAINST DEFECTS IN QUALITY AND MATERIALS UNDER NORMAL USE.
2. IN CASES BELOW, SERVICE FEE CAN BE CHARGED EVEN WITHIN WARRANTY PERIOD..
 - A. FAILURE CAUSED BY CUSTOMER'S FAULT
 - B. FAULURE CAUSED BY NATURAL DISASTERS.
 - C. FAILURE CAUSED BY REPAIRMENT OR REPLACEMENT OF THE PRODUCT WITHOUT OFFICIAL APPROVAL.
 - D. WHEN WARRANTY IS NOT SUGGESTED OR UNSTATED
3. SERVICE FEE MUST BE CHARGED AFTER WARRANTY PERIOD.



www.kenho-products.com

